

## 9. Output Clutch Pressure Test

### A: INSPECTION

#### CAUTION:

- Directly after the vehicle has been running or the engine has been idling for a long time, the CVTF is hot. Be careful not to burn yourself.
- Make sure no other person is around the vehicle during output clutch pressure test measurement.
- After performing the output clutch pressure test measurement, adjust the CVTF level.

1) Lift up the vehicle.

2) Remove the output clutch pressure test plug, and install ST1, ST2 and ST3.

#### CAUTION:

- Be careful when setting tools so that the hoses do not touch the exhaust pipes.
- Be careful when setting tools so that the front wheel speed sensor harness does not touch ST1 and ST2.

#### NOTE:

Use ST1 (PRESSURE GAUGE ADAPTER) with genuine O-ring (part No. 806916050) attached.

# Output Clutch Pressure Test

## CONTINUOUSLY VARIABLE TRANSMISSION

ST1	18681AA000	PRESSURE GAUGE ADAPTER
ST2	498897800	OIL PRESSURE GAUGE ADAPTER SET
ST3	18801AA000	OIL PRESSURE GAUGE ASSY

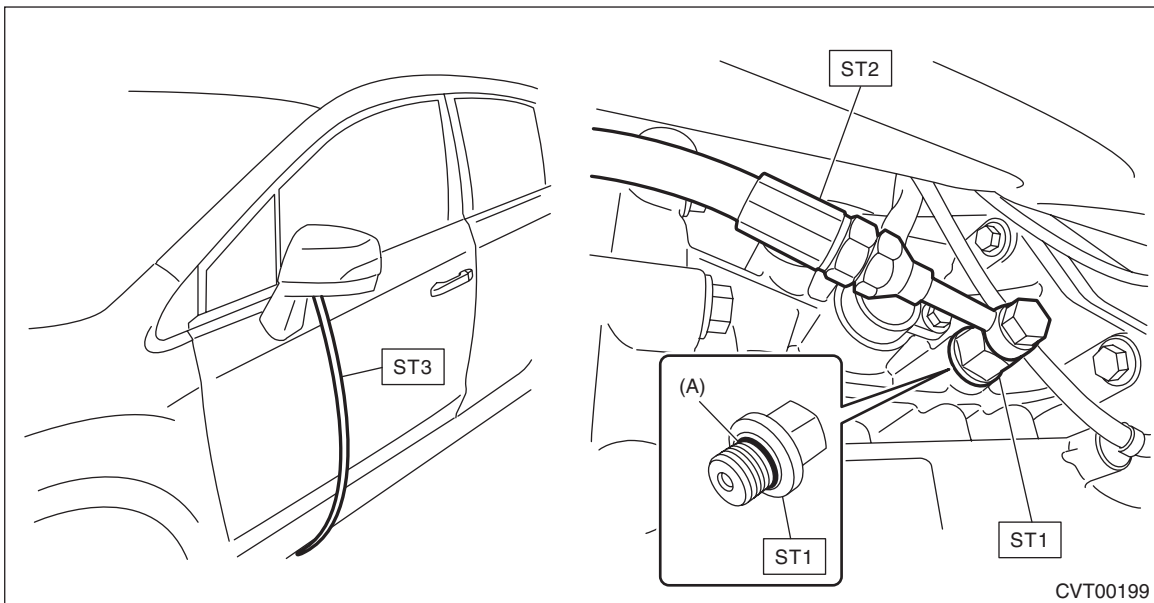
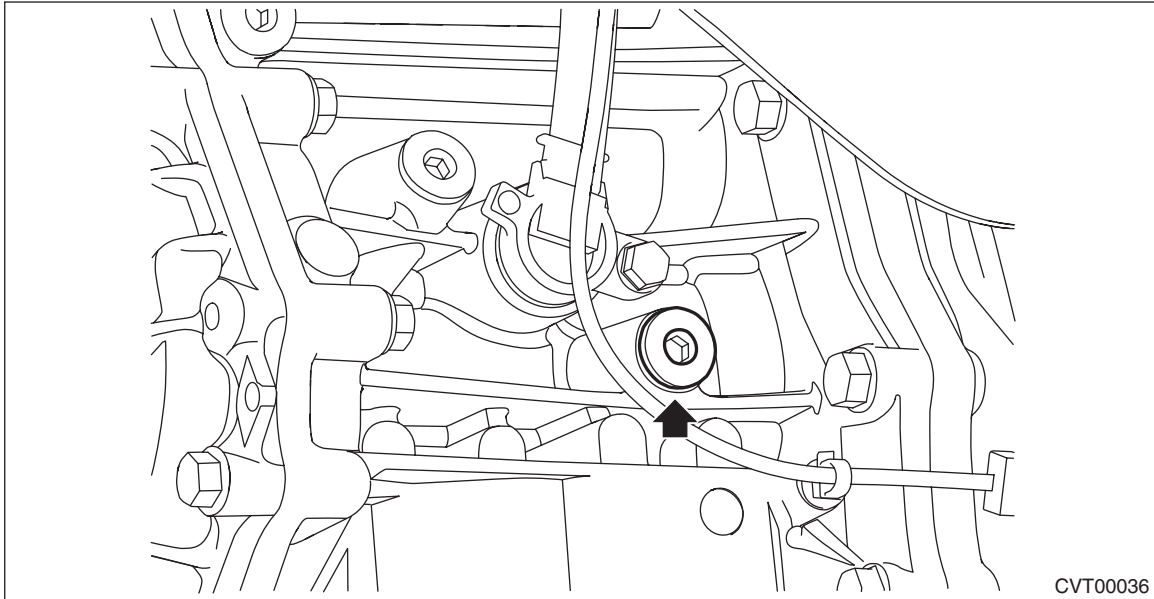

(A) O-ring (genuine part)

3) Lower the vehicle.

## Output Clutch Pressure Test

CONTINUOUSLY VARIABLE TRANSMISSION

- 4) Connect the Subaru Select Monitor to the data link connector and read the current data.  
5) Check the output clutch pressure as in secondary pressure (line pressure) test. <Ref. to CVT(TH58A)-54, Secondary Pressure (Line Pressure) Test.>

Output clutch pressure standard value				
	Range	Throttle	Brake	MPa (kgf/cm <sup>2</sup> , psi)
Stall	D	Full open	ON	1.5 — 4.0 (15.3 — 40.8, 217.5 — 580)
Idling (Engine speed: 1,000 r/min or less)	N	Full closed	OFF	0.5 — 1.3 (5.1 — 13.3, 72.5 — 188.5)

- 6) Lift up the vehicle.  
7) Remove the ST and install the plug.

**NOTE:**

- Use new O-rings.
- Apply CVTF to the O-ring.

***Tightening torque:***

***25 N·m (2.5 kgf-m, 18.4 ft-lb)***

- 8) Adjust the CVTF level. <Ref. to CVT(TH58A)-41, ADJUSTMENT, CVTF.>